

Hogstead Survey

From the point 327. ft S and 516.2 ft E, of the Cor. of Secs 26-27-35-36, I ran E.

558.5 fence, S.W. + N.E. 15 ft S. of fence E + W, bearing $71^{\circ} 30' W.$ + $51^{\circ} 30' E$
960. center of C.P.R.R., from which the 1/4 Sec. Cor. a stake and stone. on N. line of Sec. 36, bears $77^{\circ} 38' E$. 1316. ft dist by actual measurement.

Thence I ran $518^{\circ} 30' E$, along center of C.P. Ry a fence runs N., along N. side of st.

534 " " " " S. " " This point is 273.7 ft E. of Chuggs N.W. Cor. and 197. ft E. of his N.E. cor. 743.5 set stake in cent. C.P.Ry. on line of fence running S. lat Chuggs

Thence I ran $50^{\circ} 28' W$ leaving center of Ry track

210. set hub, 2.5 ft E. of post at N. end of fence survey south on line lat Chuggs on N. + Hogstead on E. 4 ft N. of road, bears $8^{\circ} E$. and 331.7 ft E. a fence runs $74^{\circ} S$. on Chuggs N. line.

I continue $50^{\circ} 28' W$. + $51^{\circ} 30' E$ parallel of fence new meas. of fence set hub, 6 ft E. of fence, and on N. side 15 ft wide leadly, S.W. to Thos D. Brown's land 516 ft $73^{\circ} 30' E$, from Chuggs S.W. cor. + 283. ft $73^{\circ} 30' E$. from Harrisville Canal course N.W. Thence along street or alley 18 ft wide - this line runs 6 ft E. of fence $74^{\circ} S$ set hub on N. bank of Harrisville Canal N.W. and 8.5 ft E. of fence $74^{\circ} S$ + 13 ft N. of fence $74^{\circ} S$ S.W. cor. Hogstead house bears $76^{\circ} 25' E$ 154.9 ft S.W. cor. of another house owned by him and his residence bears $78^{\circ} 45' E$. 297. ft dist from this point fence along his S. line bears $78^{\circ} 45' E$. 367. ft to cent. C.P.Ry., from which the 1/4 Sec. cor. bears $53^{\circ} 25' E$, 1797.5 ft dist actual measurement.

2317.6

Nov. 27 1896. Description of H.C. Hogstead's Claim. T. 7. N. R. 2. W. Sec. 36. T. 7. N. R. 2. W. Beg. at point 1798.6 ft N. $5^{\circ} 02' W$. From S.E. cor. S.W. $1/4$ Sec. $118^{\circ} 28' W$ 249.8 ft post, 50 ft W. at r.m. from Cent. C.P.R.R. - $50^{\circ} 45' W$ 1877.4 ft, $78^{\circ} 40' E$ 215 ft, $50^{\circ} 25' W$ 497.1 ft, along E. side alley 800.9 ft. to 829, 22.16 a.

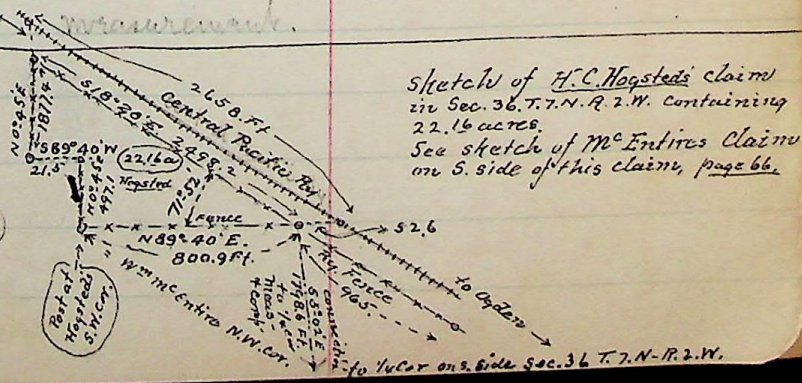

Sketch of H.C. Hogstead's claim in Sec. 36. T. 7. N. R. 2. W. containing 22.16 acres. See sketch of McEntire's claim on S. side of this claim, page 66.